

4.5.

półki z prawej - widok przód/tył

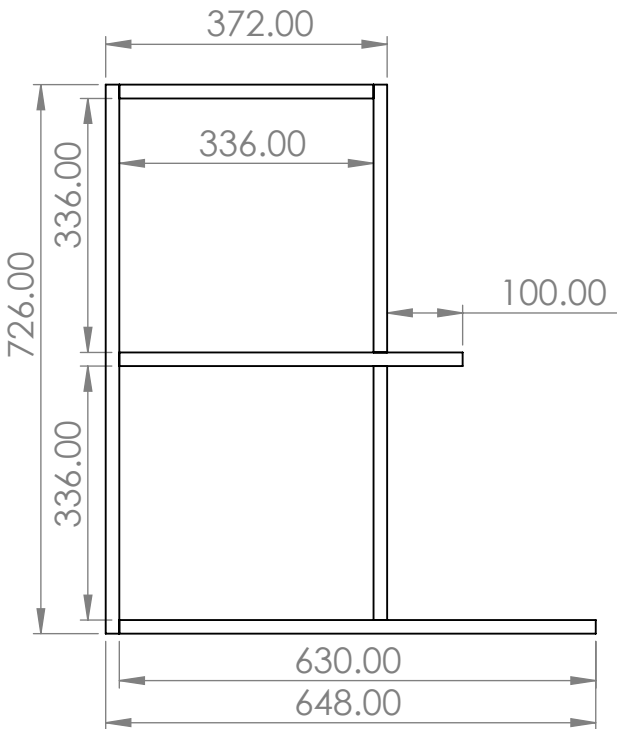

widok z prawej

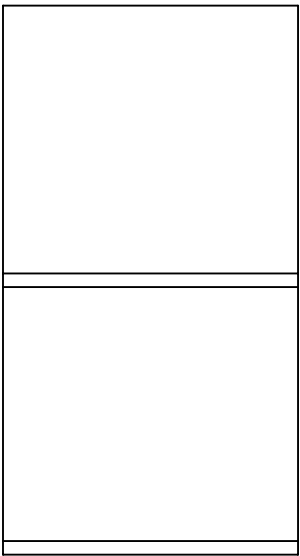

widok 3d

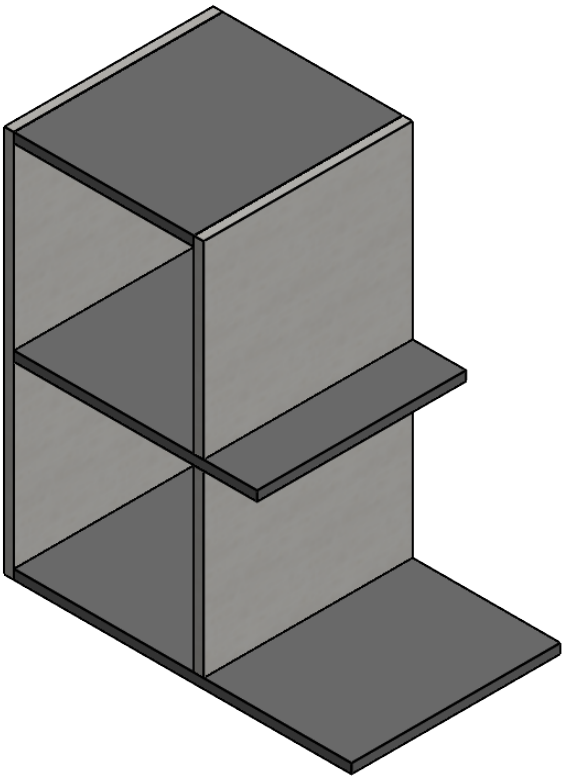

widok z góry

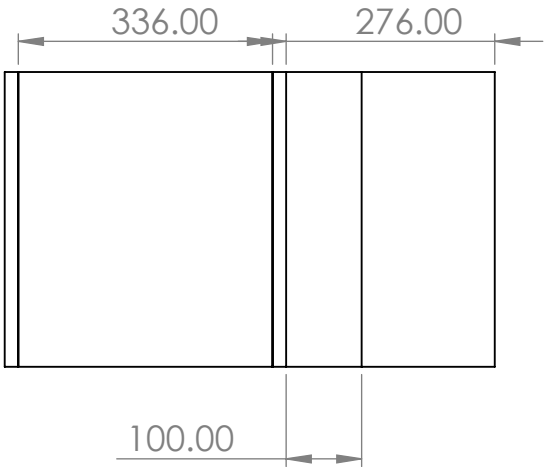

UNLESS OTHERWISE SPECIFIED:  
DIMENSIONS ARE IN MILLIMETERS  
SURFACE FINISH:  
TOLERANCES:  
LINEAR:  
ANGULAR:

FINISH:  
plyta meblowa - laminat  
"drewno białe północne"

DEBURR AND  
BREAK SHARP  
EDGES

DO NOT SCALE DRAWING

REVISION

	NAME	SIGNATURE	DATE	
DRAWN				
CHK'D				
APPV'D				
MFG				
Q.A				

MATERIAL:  
plyta meblowa 18 mm

WEIGHT:

TITLE:  
półki z prawej strony  
- wymiary + info

DWG NO.

Studio 1.6

A4

SCALE:1:10

SHEET 1 OF 1